

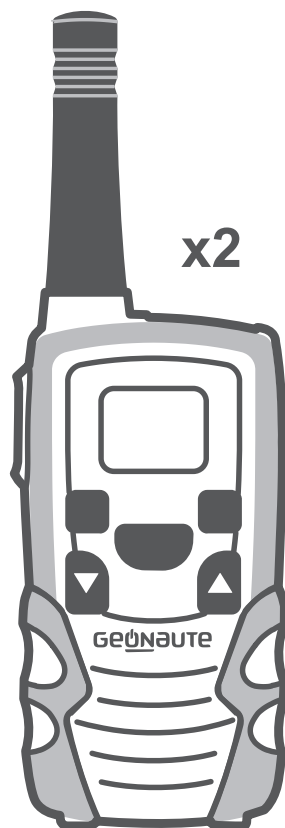

CONTENTS

1	PRECAUTIONS FOR USE	2
2	DESCRIPTION	3
3	INSTALLATION.....	4
3.1	Installing the Battery	4
3.2	Installing / removing the belt clip.....	4
3.3	Charging the batteries.....	4
4	OPERATION	6
4.1	Transmission range.....	6
4.2	Turning the unit On/Off.....	6
4.3	Adjusting the speaker volume.....	6
4.4	Changing Channels	6
4.5	Transmitting (sending a speech).....	7
4.6	Monitor.....	7
4.7	Setting the VOX (Voice Activated Sensitivity).....	8
4.8	Activating the Auto channel scan	8
5	CALL-RING TONE.....	9
5.1	Selecting a Call-ring tone.....	9
5.2	Setting the Roger beep	9
5.3	Setting the key tone On or Off.....	9
5.4	Setting the Dual Watch Mode	9
6	AUXILIARY FEATURES	10
6.1	Key lock	10
6.2	LCD screen back light.....	10
6.3	Microphone/Earphone/Charge jack	10
7	ACCESSORIES	11
7.1	Using the earpiece kit.....	11
7.2	Installing the elastic strap.....	11
8	TECHNICAL CHARACTERISTICS	11
8.1	Specifications	11
8.2	Channel frequency table	11
9	CE DECLARATION OF CONFORMITY	11
10	WARRANTY.....	12
11	RECYCLING	12
12	CONTACT US	12



x2

+

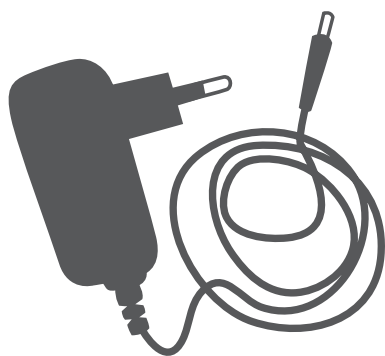

x1

+

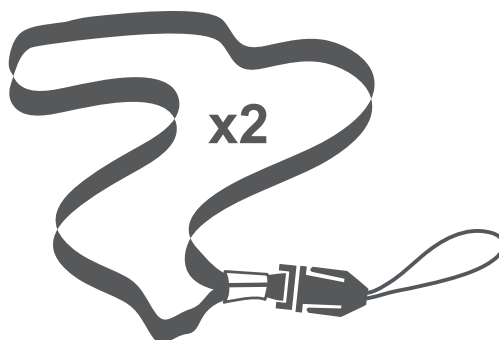

x2

+



x2

x1

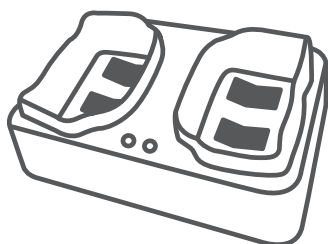

+



AAA

x6

1 PRECAUTIONS FOR USE



- Please read the owner's manual carefully before use. Please keep the owner's manual for the entire life of the product.
- To reduce radio frequency exposure when using the device, keep it at least 5 cm away from your face.
- Do not allow babies or young children to get near the devices.
- Never use a walkie-talkie with a damaged antenna. If the antenna is in contact with the skin, mild burns may result.
- When using the device in a vehicle, do not leave it in the area above an airbag or in the airbag deployment area because it can be propelled with great force and cause serious injury to the vehicle occupants if the airbag is deployed.
- The devices are designed to be used in temperatures ranging from -10°C to +50°C inclusive.
- If the devices are used in low temperatures, you must use batteries capable of standing up well to low temperatures. Preferably use lithium or NiMH rechargeable batteries as alkaline and zinc batteries perform very badly in low temperatures.
- Do not use the devices or change the batteries in an explosive atmosphere. The antenna or batteries can produce micro-sparks or static electricity which can set off explosions causing serious injury and even death.
- Never use the device outside during a storm.
- Do not use the device in the rain.
- If the device gets wet, switch it off and remove the battery. Dry the battery compartment and leave the cover open for a few hours. Do not use the device until it is completely dry.
- Do not dismantle the product. This will void the warranty and could cause damage or loss of watertightness.
- Clean the product with a soft, moist cloth or a compressed air canister. Never use detergents as they could cause damage to the materials. Do not rub the screen with anything that might scratch it.
- Remove the batteries before storing the device for a prolonged period.

2 DESCRIPTION

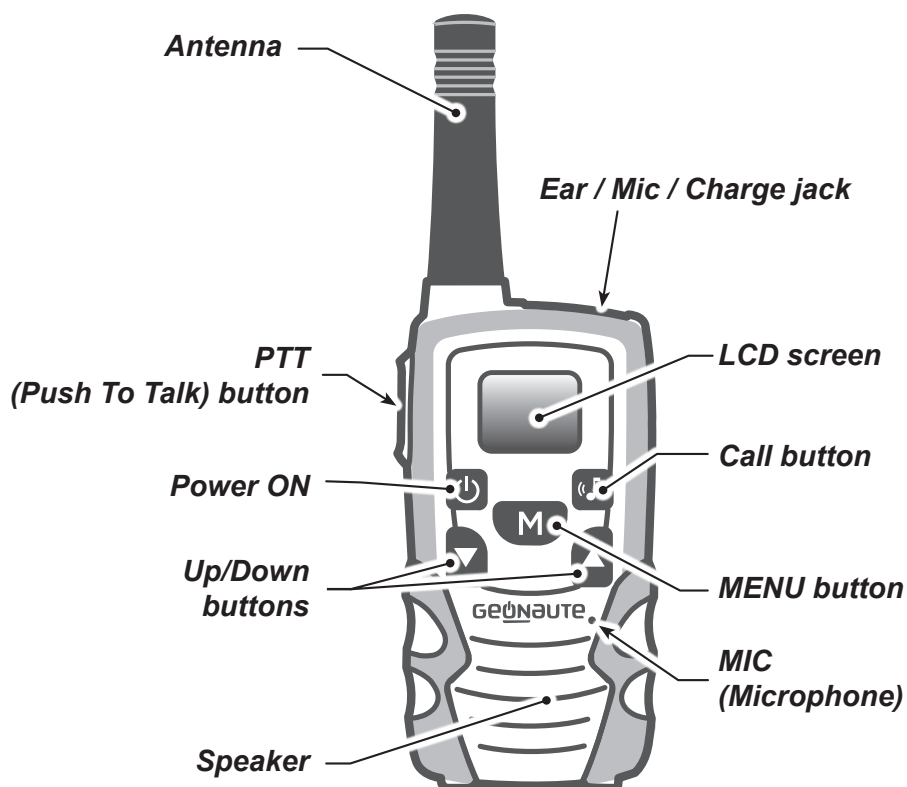

LCD screen

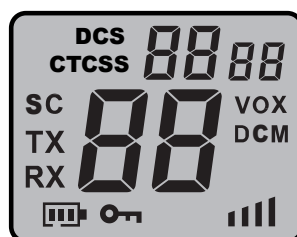

8888	Channel number. Changes from 1 to 8 as selected by the user.
88	CTCSS code. Changes from 1 to 38 as selected by the user.
	Displays the Battery charge level. When the bars are reduced, the battery needs recharging.
TX	Displayed when at transmitting a signal.
RX	Displayed when at receiving a signal.
DCM	Displayed when Dual Watch function is ON.
DCS	Displayed when Digital Code System is ON.
VOX	Displayed when VOX is activated.
SC	Displayed when PMR scanning the channels.
	Displayed when the key lock is activated.
	Displayed current speaker volume level.

3 INSTALLATION

3.1 Installing the Battery

If the belt clip is installed, remove it.

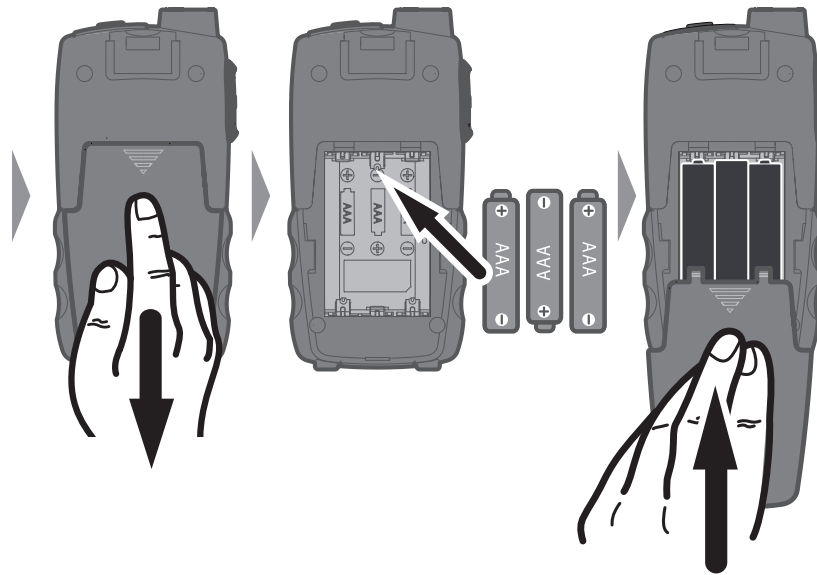

Observe the proper battery polarity orientation when installing batteries. Incorrect positioning can damage both the batteries and the unit.

3.2 Installing / removing the belt clip

Installing the Belt clip

→ Slide the belt clip into the slot as shown in figure.

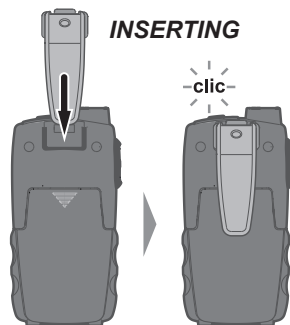

REMOVING

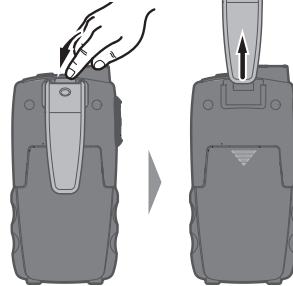

Removing the Belt clip

→ Pull up the Belt clip latch from the ONchannel 510.
→ While pulling the Belt clip latch, push up the belt clip as shown in figure.

3.3 Charging the batteries



Important: Read these Safety Warnings before you charge the batteries.

- When placing the ONchannel 510 in the charger, use only the power supply On Real provided to this model ONchannel 510.
- Don't try to recharge non-rechargeable batteries.
- Make sure the battery compartment cover is securely locked in place when you are charging the batteries.
- Dispose of used batteries safely and in a way that will not harm the environment. Never try to burn them or put them anywhere, they could get burnt or punctured.
- Don't leave dead batteries in your ONchannel 510 units. They might leak if you do.

→ Insert the USB plug on the end of the mains adaptor into the power-in connection jack at the back of the desktop charger.

- Plug the mains adaptor into a 240 VAC, 50 Hz main socket with the switch on the socket set to Off.
- Switch On the main socket.



- The ONchannel 510 must be charged using the mains adaptor provided.
- Using any other adaptor will result in non-compliance with EN60950-1 and will invalidate any approvals & warranty.

- Place the ONchannel 510 units in the charge cradle in an upright position.

The charge LED indicators will light up.

- It takes about 10 hours to fully recharge the batteries if they are completely run down.

New batteries take up to 14 hours to fully charge.

Important: Always turn off the PMR units when charging. This will shorten the charging time.

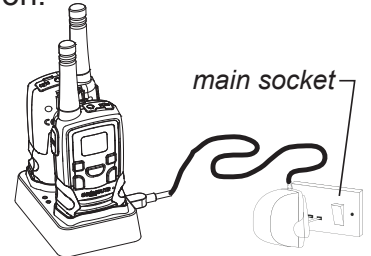

- Charging the battery batteries (using adaptor).

Lift the charge socket cover located on the upper side of the handset.

- Insert the USB connector of the 5.0 VDC/550 mA adaptor into the charge jack.
- Plug the mains adaptor into a 240 VAC, 50 Hz main socket with the switch on the socket set to Off. Use only the power supply On Real provided to this model. Then switch On the main socket.

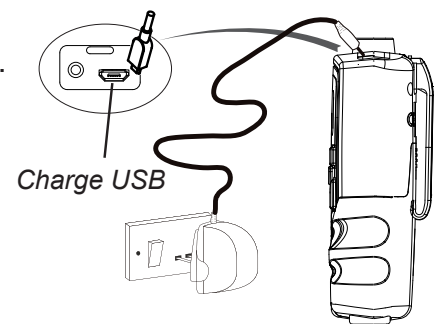

3.3.1 Battery meter

The battery meter is located in the left corner of the LCD screen. It appears like a battery with three bars inside. These indicate the amount of power available. When the battery level reaches its minimum level in PMR on mode, unit will emit two beep tones and automatically the unit will power off.

The ONchannel 510 can detect the battery charge in 4 levels;



Battery charge at high level.



Battery charge at medium level.



Battery charge at low level. At this level, the ONchannel 510 will emit a "beep" sound for every 10 seconds in normal mode.



Battery charge at very low level. When the battery level reaches its minimum level in ONchannel 510 on mode, unit will emit two "beep" tone and automatically turn off the power and proceeds to watch mode.

Important: Charge the unit for 10-14 hours.



Risk of explosion if battery is replaced by an incorrect type. Dispose of used batteries according to the instructions.

3.3.2 Battery life

The ONchannel 510 has a built-in power saver to make the batteries last longer. But when you are not using the units, turn them Off to conserve battery power.

4 OPERATION

4.1 Transmission range

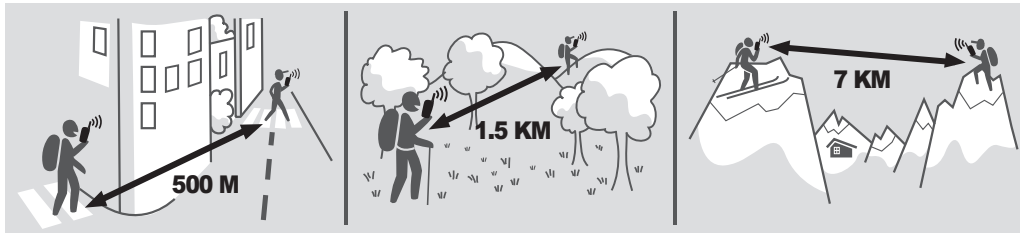

Important safety warning:

- To reduce radio frequency exposure when you are using your ONchannel 510, hold the unit at least 5 cm (2 inches) away from your face.
- Never use your ONchannel 510 outdoors during a thunderstorm.
- Don't use the ONchannel 510 in the rain.
- If your ONchannel 510 gets wet, turn it off and remove the battery. Dry the battery compartment and leave the cover off for a few hours. Don't use the unit until it is completely dry.
- Keep the ONchannel 510 out of reach babies and young children.

4.2 Turning the unit On/Off



To Turn On;

→ Press and hold **Power** button until the LCD screen turns On and display the current channel.

To switch Off;

→ Press and hold **Power** button until the LCD screen turns blank.

4.3 Adjusting the speaker volume



→ Press **Up** or **Down** button to increase or decrease the volume. The LCD screen will display the speaker volume icon bars according to the settings.

4.4 Changing Channels

The ONchannel 510 has 8 available channels, to communicate with other ON310 users within a range, you must have your radio tuned to the same channel.



→ Press the **Menu** button once, the current channel number flashing on the LCD screen.



→ Press the **Up** or **Down** button to select the desired channel. The channel changes from 1 to 8, or vice versa.



→ Press the **PTT** button to confirm the setting.



- Refer to the «Channel Table» section of this Owner's manual for detailed frequency listing.

4.4.1 Setting the CTCSS sub-channel

Each channel also has 38 sub-channels to let you set up group of users within the same channel for more private communication. If you have set the sub-channel, you can only communicate with other PMR users tuned to the same channel and sub-channel.

To turn the sub-channel function off: simply set the sub-channel to 0 (zero). You can communicate with any ONchannel 510 user set to the same channel who also turns off the sub-channel operation (or whose have unit does not have the feature).



→ Press the **Menu** button twice, the current CTCSS sub-channel number flashing on the LCD screen.



→ Press the **Up** or **Down** button to select one of the 38 CTCSS sub-channels.



→ Press the **PTT** button to confirm the setting.

4.4.2 Setting the DCS (Advanced Digital Code).

Each channel also has 83 digital codes to let you set up group of users for more secured private communication.



→ Press the **Menu** button 3 times. DCS code is blinking on the LCD screen.



→ Press the **Up** or **Down** button to select the desired DCS code.



→ Press the **PTT** button to confirm the DCS channel setting.

Transmitting and Receiving

- The ONchannel 510 transmission is «one way-at-a-time.» While you are speaking, you can not receive a transmission.
- The ONchannel 510 is an open-license band. Always identify yourself when transmitting on the same channel.

4.5 Transmitting (sending a speech)

The unit is continuously in the receive mode when the unit is turned On and not transmitting. When a signal is received on the current channel, «RX» icon will be displayed on the LCD screen.

→ Press and hold the **PTT** button to transmit your voice. «**TX**» icon will be displayed on the LCD screen.



→ Hold the unit in a vertical position with the MIC (Microphone) 5 cm away from the mouth. While holding the **PTT** button, speak into the MIC (microphone) in a normal tone of voice.

→ Release the **PTT** button when you have finished transmitting.

4.6 Monitor

You can use the Monitor feature to check for weak signals on the current channel.



→ Press and hold the **Menu** and **Down** button.



The "**RX**" icon will be displayed on the LCD screen. Your ONchannel 510 will pick up signals on the current channel, including background noise.



→ Press the **Menu** button again to stop the channel monitoring.

4.7 Setting the VOX (Voice Activated Sensitivity)

In «**VOX**» mode, the ONchannel 510 will transmit a signal only when it is activated by your voice or other sounds around you. The unit will transmit further for 2 seconds even if you stop talking.

The level of «**VOX**» sensitivity is shown by a number on the LCD screen. At the highest level, the units will pickup softer noise (including background noise), at the lowest level, it will pick up only quite loud noise.



→ Press the **Menu** button 4 times, "**VOX**" icon will be displayed and "**OFF**" flashing on the LCD screen.



→ Press the **Up** button to set the VOX sensitivity into maximum level (the maximum level is "3").

→ To deactivate the VOX function, press the **Down** button until "**OFF**" appears on the LCD screen.



→ Press the **PTT** button to confirm your setting. "**VOX**" will steadily appear on the LCD screen as long as the VOX feature is activated.



- VOX operation is not recommended if the ONchannel 510 will be used in a noisy or windy environment.

4.8 Activating the Auto channel scan

Channel scan perform searches for active signals in an endless loop for all 8 channels, 38 CTCSS codes and all 83 DCS codes.



→ Press the **Menu** button 5 times, "**SC**" icon will display on LCD screen.



→ Press the **Up** or **Down** button to begin scanning channels. When an active signal is detected, channel scan pauses on the active channel.



→ Press the **Menu** button six times, CTCSS flashing on the LCD screen.



→ Press the **Up** or **Down** button to begin scanning the CTCSS from 1-38.



→ Press the **Menu** button seven times, DCS flashing on the LCD screen.



→ Press the Up or Down button to begin scanning DCS code 1-83.



→ Press the **PTT** button to return to standby mode.

5 CALL-RING TONE

You can send a Call-ring tone to other PMR users to give an alert that you want to communicate with them.



→ Press the **Call** button

You will hear a ring tone for about two seconds. «**TX**» icon appears on the LCD screen. Any other units within the transmitting range and tuned to the same channel and sub-channel (if applicable) will hear the Call-ring tone.

5.1 Selecting a Call-ring tone

The ONchannel 510 is equipped with 15 different types of Call ring tones.



→ Press the **Menu** button 8 times, the "**C01**" icon will display and flashing on the LCD screen.



→ Press the **Up** or **Down** button to select the desired call ring tone.

A respective call ring tone sound will be played when changing from one tone to another.



→ Press the **PTT** button to confirm your setting.

5.2 Setting the Roger beep

The Roger beep is a tone which is automatically transmitted whenever the **PTT** button is released. This alerts the receiving party to inform that you have intentionally ended the transmission, and you are now in receive mode.



→ Press the **Menu** button 9 times, the «**ON**» icon is blinking on the LCD screen.



→ Press the **Up** or **Down** button to select the Roger beep On/Off.



→ Press the **PTT** button to confirm your setting.

5.3 Setting the key tone On or Off

This feature allows the ONchannel 510 to emit a confirmation tone after pressing each button.



→ Press the **Menu** button 10 times, the "**ON**" icon is blinking on the LCD screen.









→ Press the **Up** or **Down** button to select the key tone On/Off.



→ Press the **PTT** button to confirm your setting.

5.4 Setting the Dual Watch Mode





Your ONchannel 510 is capable of monitoring two channels, the current and another (dual watch) channel. If the unit detects a signal on either channel, it will stop and receive the signal.

-  → Press the **Menu** button 11 times, "**DCM**" icon will be displayed while "**OFF**" flashing on the LCD screen.
-  → Press the **Up** or **Down** button to select the Dual Watch channel (1-8, except the current channel).
-  → Continue pressing the **Menu** button to change the CTCSS code.
-  → Press the **Up** or **Down** button to select the desired CTCSS code (1-38)
-  → Continue pressing the **Menu** button to change the DCS code.
-  → Press the **Up** or **Down** button to select the desired DCS code (1-83)
-  → Press the **PTT** button to confirm your setting.

6 AUXILIARY FEATURES

6.1 Key lock

The key lock feature allows user to disable the **Up**, **Down** and **Menu** buttons so that the ONchannel 510 settings could not be changed accidentally.

-  → To activate the key lock feature, press and hold the **Menu** button until key lock «» icon appears on the LCD screen.
-  → To deactivate the key lock feature, press and hold the **Menu** button until key lock «» icon disappears on the LCD screen.
-  • The **PTT**, and **CALL** buttons will remain functional even if the key lock feature is activated.

6.2 LCD screen back light

Every time the **Power** button is open (except **CALL** and **PTT**), the LCD screen back light will illuminate for 5 seconds.

6.3 Microphone/Earphone/Charge jack

The ONchannel 510 is equipped with an auxiliary microphone, earphone, and charge jack located at the upper side of the unit.

- You can plug a hands free kit into the earset / mic jack hole of your radio handset. With hands free kit, by pressing the **PTT** button it will transmit and talk with other radios.

7 ACCESSORIES

7.1 Using the earpiece kit

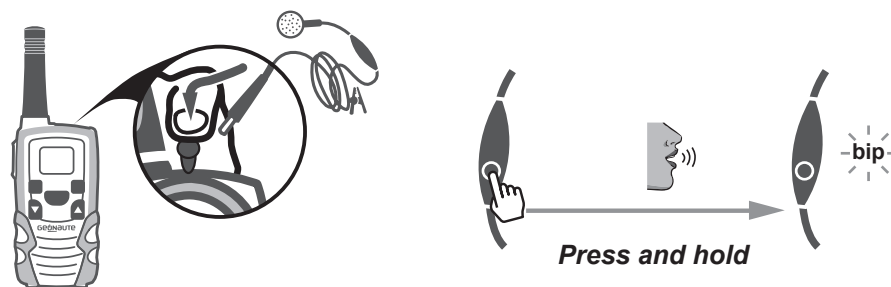

- When the earphone kit is installed, the microphone and loudspeaker are deactivated.

7.2 Installing the elastic strap

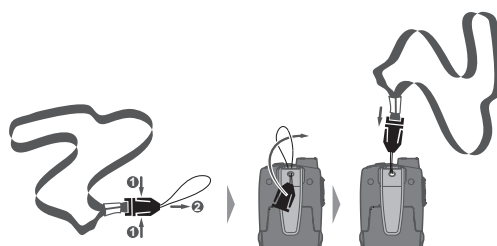

8 TECHNICAL CHARACTERISTICS

8.1 Specifications

Channels Available	8 channels.
CTCSS sub-channel	38 for each channel.
DCS sub-channel	83 for each channel.
TX 5%, RX 5%, Standby 90%	11 hours.
Output power (TX)	0.5 W.
Range	Up to 7 Km (in open space).

8.2 Channel frequency table

Channel	Frequency (MHz)	Channel	Frequency (MHz)
1	446.00625	5	446.05625
2	446.01875	6	446.06875
3	446.03125	7	446.08125
4	446.04375	8	446.09375

9 CE DECLARATION OF CONFORMITY

- **DECATHLON** hereby declares that the ONchannel 510 device complies with the essential requirements and other relevant provisions of Directive 1999/5/CE
- **DECATHLON** hereby declares that the ONchannel 510 device complies with the essential requirements and other relevant provisions of Directive 2006/95/CE.

Compliance with these required conditions is expressed by the marking: **CE**

The CE declaration of conformity is available via the following link: <https://www.geonaute.com/en/ec-declaration-conformity>

10 WARRANTY

DECATHLON guarantees to the initial purchaser of this product that it is free from material or manufacturing defects. This product is guaranteed for two years from the date of purchase. Please ensure that you keep the invoice as proof of purchase.

The guarantee does not cover:

- Damage resulting from misuse, from a failure to respect the precautions for use, from accidents, from improper maintenance or from commercial use of the product.
- Damage resulting from repairs carried out by persons not authorised by **DECATHLON**.
- Batteries or casings which are cracked or broken or which show signs of impacts.
- The elastic strap, which is subject to wear and tear.

During the warranty period, the item will either be repaired free of charge by an authorised repair service or replaced free of charge (depending on the distributor).

11 RECYCLING

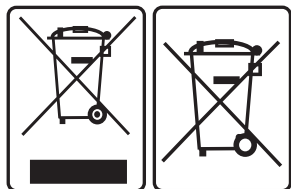

The «crossed-out bin» symbol means that this product and the batteries it contains must not be thrown away with general household waste. They are subject to a specific type of sorting. Please take the batteries and your unusable electronic product to an authorised collection point for recycling. This treatment of your electronic waste will protect the environment and your health. Dispose of your batteries in a place where they will be recycled.

12 CONTACT US

We would like to hear your views on the quality, features and use of our products at:

www.support.geonaute.com

We will reply as soon as possible.

GEONAUTe.COM

Made in China
Fabricado na China
Произведено в Китае
İmal edildiği yer Çin
中国 制造
中國 製造

以下标示仅在中国大陆地区适用
产品等级：合格品
质检证明：合格
商标:Geonaute

上海莘威运动品有限公司,
上海市闵行区申北路2号
邮编:201108

台灣迪卡儂有限公司
台灣台中市408南屯區大墩南路379號
諮詢電話：(04) 2471-3612

540-0011
大阪市中央区農人橋1-1-22
大江ビル10階
ナチュラムイーコマース株式会社
IMPORTADO PARA BRASIL POR IGUASPORT Ltda
CNPJ : 02.314.041/0022-02

для занятий спортом
Импортер: ООО «Октобл», 141031, Россия,
Московская область, Мытищинский район, МКАД
84-й км., ТПЗ «Алтуфьево», владение 3, строение 3,
+7(495)6414446

TURKSPORT Spor Ürünleri Sanayi ve Ticaret Ltd.Şti
Osmaniye Mahallesi Çobançeşme Koşuyolu
Bulvarı No: 3 Marmara Forum Garden Office
0B Blok 01 Bakırköy 34146 İstanbul, TURKEY

Pack Ref : 723.265

DECATHLON

Производитель и адрес, Франция:
DECATHLON - 4 Boulevard de Mons - BP 299
59665 Villeneuve d'Ascq cedex - France

